

LSTS Towel Rail



Product Description

'S' shaped towel warmer designed to meet the NHS recommendations on safe surface temperatures, with a maximum surface temperature of 43 degrees celsius.

Key Features

- Dry element tubular steel towel rail
- Durable white enamel finish
- Surface temperature regulated to 43 degrees celsius
- Splash-proof (IPX4 rated) for use in bathrooms and other wet areas
- Easy, fast installation

Technical Details

Thermal cut-out	Surface temperature regulated to a maximum of 43 degrees celsius by automatic resetting thermal cut-out
Installation	Suitable for wall mounting only. Can be mounted with left or right hand cable entry.
Cable	3 core cable – live, neutral, earth. Installations must be in accordance with latest IEE regulations.
Construction	Tubular steel construction. Dry element.
Class	Class I
IP Rating	IPX4
Colour / Finish	White enamel
Approvals	CE and BEAB
Warranty	2 years
Country of Origin	Ireland
Manufacturer	Dimplex UK

Dimensions

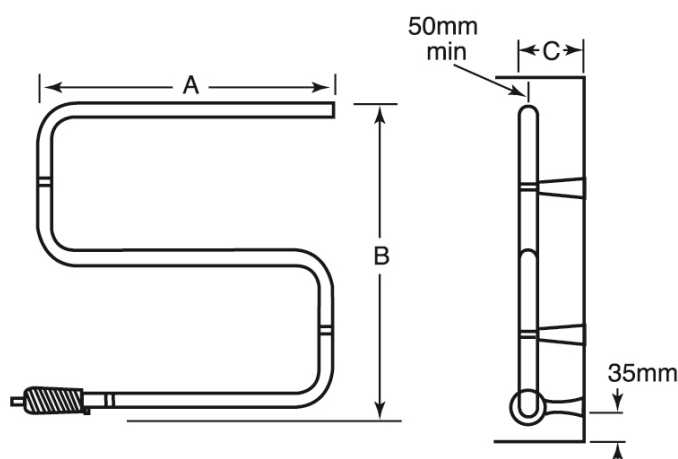

Model No.	Output W	Height (B) mm	Width (A) mm	Colour	Depth (C) mm	Weight kg
LSTS	15	555	568	White	93	1.7

Packaging Details

Model No.	Length	Height	Depth	Barcode
LSTS	585	635	75	5011139 055484

Additional Information

Model No.	Ti	Hi	Pallet Quantity (2.4m high)
LSTS	25	2	50