

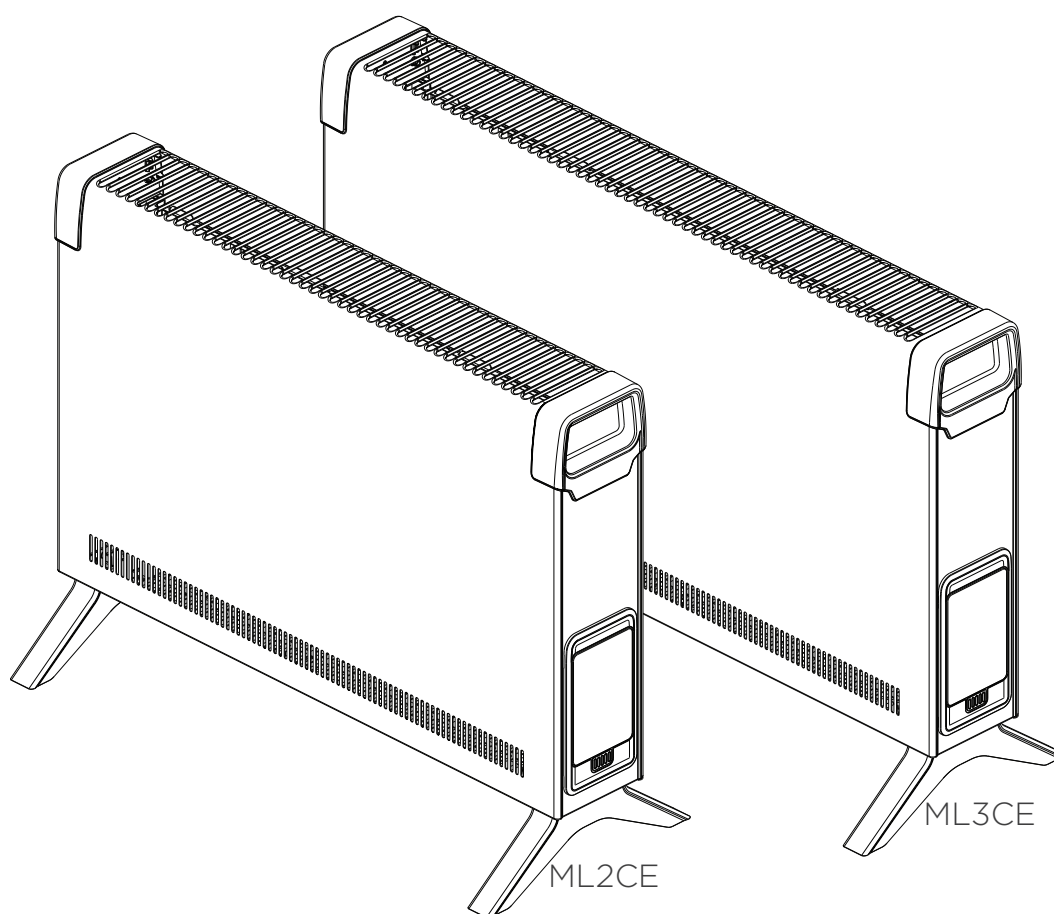

ML SERIES



Convector Heater
ML2CE & ML3CE

Designed to provide gentle background heating, to take the chill off a room. Ideally to be used with a principal source of heating.

As with all portable heating appliances: This product is suitable only for well insulated spaces or occasional use.



These products comply with all the required European and UK Product Safety, Electromagnetic Compatibility and Environmental Standards. They are fully compliant with the LVD, EMC, RoHS and Eco Design Directives and Regulations.

Installation and Operating Instructions

IMPORTANT: THESE INSTRUCTIONS SHOULD BE READ CAREFULLY BEFORE USE AND RETAINED FOR FUTURE REFERENCE

IMPORTANT SAFETY ADVICE

WARNING: To avoid danger of suffocation please remove all packaging materials particularly plastic and EPS and keep these away from vulnerable people, children and babies.

WARNING: To avoid the risk of accidental strangulation from the supply cord all children and vulnerable people must be supervised when in the vicinity of the product whether it is working or not.

DO NOT pull, carry or move the appliance using the power cable.

DO NOT use the heater in the immediate surroundings of a bath, a shower or a swimming pool.

DO NOT place the heater directly below a fixed socket outlet.

The socket-outlet must be accessible at all times to enable the mains plug to be disconnected as quickly as possible.

WARNING: In order to avoid overheating, do not cover the heater.



This heater carries the warning symbol indicating that it must not be covered.

DO NOT cover or obstruct the air inlet and outlet openings in any way.

DO NOT use this heater in small rooms when they are occupied by persons not capable of leaving the room on their own, unless constant supervision is provided.

IMPORTANT: If the mains lead of this appliance is damaged, it must be replaced by the manufacturer or its service agent or a similarly qualified person in order to avoid a hazard.

CAUTION: In order to avoid a hazard due to inadvertent resetting of the thermal cut-out, this appliance must not be supplied through an external switching device, such as a timer, or connected to a circuit that is regularly switched on and off by the utility.

This appliance can be used by children aged from 8 years and above and persons with reduced physical, sensory or mental capabilities or lack of experience or knowledge if they have been given supervision or instruction concerning the use of the appliance in a safe way and understand the hazards involved. Children shall not play with the appliance. Cleaning and user maintenance shall not be made by children without supervision.

Children of less than 3 years should be kept away unless continuously supervised.

Children aged from 3 years and less than 8 years shall only switch on/off the appliance provided that it has been placed or installed in its intended normal operating position and they have been given supervision or instruction concerning the use of the appliance in a safe way and understand the hazards involved. Children aged from 3 years and less than 8 years shall not plug in, regulate and clean the appliance or perform user maintenance.

CAUTION: Some parts of this product can become very hot and cause burns. Particular attention has to be given where children and vulnerable people are present.

DO NOT use this heater if it has been dropped.

DO NOT use if there are visible signs of damage to the heater.

Use this heater on a horizontal and stable surface with the feet securely fitted.

WARNING: To reduce risk of fire, keep textiles, curtains, or any other flammable material a minimum distance of 1m from the appliance.

WARNING: Risk of fire - Do not use this appliance connected through an extension lead or any external switching device such as a plug in timer or remote control plug in adaptor. All heating appliances draw high current through the mains supply and any weakness in the design, connections or components in these devices can easily result in overheating of the connection points resulting in melting, distortion and even the risk of fire!

DO NOT use the heater on deep pile carpets or the long hair type of rugs, or less than 750mm (30") away from any overhanging surface. Keep combustible materials such as drapes and other furnishings clear from the front, sides and rear of the heater. Do not use heater to dry your laundry.

DO NOT operate the heater with the mains lead overhanging the outlet grill.

DO ENSURE that the mains lead cannot be tripped over.

If the radiator is tipped over, unplug it and allow it to cool before standing it back up.

IMPORTANT: The feet supplied with the appliance must be used.

This instruction leaflet belongs to the appliance and must be kept in a safe place. If changing owners, the leaflet must be surrendered to the new owner.

Dimensions & Clearances

All Dimensions in millimetres

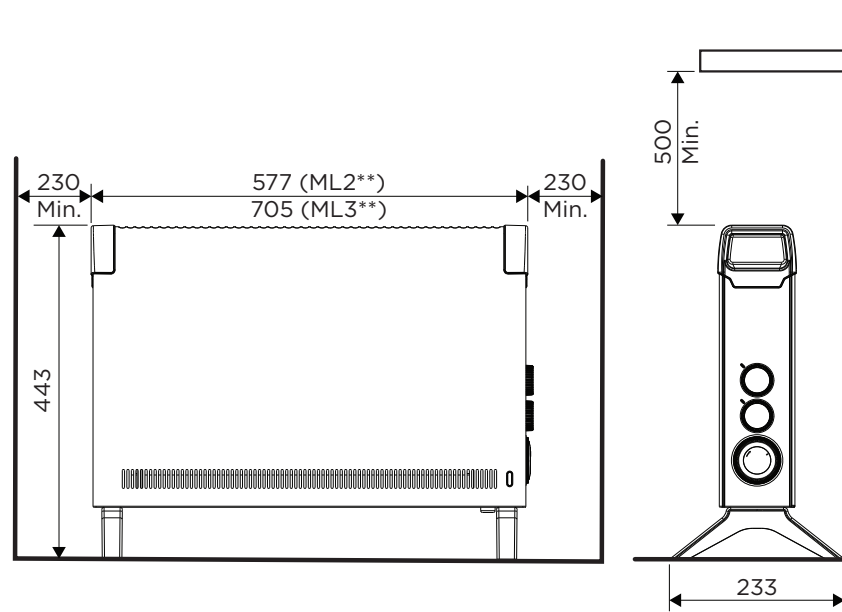

Fig. 1

Technical Data

Model Identifier(s):		ML2CE	ML3CE	
Specification				
Electronic Time & temperature control		Yes	Yes	
Heat Selection		Yes	Yes	
Feet for portable use		Yes	Yes	
Wall mountable		No	No	
Heat output				
Nominal heat output	P _{nom}	2.0	3.0	kW
Minimum heat output (indicative)	P _{min}	1.2	2.0	kW
Maximum continuous heat output	P _{max,c}	2.0	3.0	kW
Auxiliary electricity Consumption				
At nominal heat output	e _{lmax}	0.0	0.0	kW
At minimum heat output	e _{lmin}	0.0	0.0	kW
In standby mode	e _{lSB}	0.0	0.0	kW
Type of heat output/ room temperature control				
Electronic room temperature control with 12 hour runback timer		Yes	Yes	
Contact details		UK: Glen Dimplex UK Ltd., Millbrook House, Grange Drive, Hedge End, Southampton SO30 2DF ROI: Glen Dimplex Europe Limited, Airport Road, Cloghran, County Dublin, K67 VE08		

Electrical Connection

WARNING: THIS APPLIANCE MUST BE EARTHED

DO NOT use an extension lead or multi-plug adaptor when connecting this product to the mains. Connection through these devices could lead to risk of overloading, overheating and even fire at the extension lead or adaptor due to inadequate connection quality.

This heater must be used on an AC (-) supply only and the voltage marked on the heater must correspond to the supply voltage. This heater is fitted with a rewirable plug incorporating a 10/13 amp fuse. In the event of replacing the fuse in the plug supplied, an equivalent 10/13 amp fuse approved by ASTA to BS 1362 must be used. If any other type of plug is used, a 15 amp fuse must be fitted in the plug, the adaptor, or at the distribution board.

IMPORTANT: If the plug is not suitable for your socket, the 13 amp plug should be removed. Before wiring the appropriate plug, please note that the wires in this mains lead are coloured in accordance with the following code:

GREEN AND YELLOW:
BLUE:
BROWN:

EARTH
NEUTRAL
LIVE

Connect the **GREEN AND YELLOW** wire to the terminal marked '**E**' or by the earth symbol , or coloured **GREEN** or **GREEN AND YELLOW**. Connect the **BROWN** wire to the terminal marked '**L**' or coloured **RED**. Connect the **BLUE** wire to the terminal marked '**N**' or coloured **BLACK**.

General

The heater is designed for operation on an AC electricity supply, and is suitable for use in domestic dwellings and similar indoor locations.

The heater is supplied with feet and handles for ease of movement. An electronic control provides the ability to choose an available heat output and control the room temperature. It is supplied with a cord and plug and is ready for use once the feet have been correctly fitted.

Assembly and Positioning

The ML Convactor can only be used as a portable heater. To install the feet, lay the heater on its back and remove the two foot fixing screws, highlighted in Fig. 2. Assemble the feet by pressing them firmly into the convactor body as indicated in Fig. 2, the foot should clip into position. Secure using the foot fixing screw, Return the convactor to the upright position,

The appliance is now ready for use.

Always ensure that the heater is stood on a firm, level base near to, but not directly underneath a suitable mains supply socket.

Ensure that curtains and furniture are not positioned close to the chosen position.

If young children, the aged or infirm are likely to be left in the vicinity of the heater, we advise that the adequate precautions should be taken. We recommend that a guard be fitted to ensure contact with the heater is avoided and objects cannot be inserted into the product.

WARNING: PLEASE ENSURE THE MINIMUM CLEARANCE DIMENSIONS INDICATED IN Fig.1 ARE MAINTAINED

WARNING: The heater must only be operated with the feet securely fitted and in the upright position.

Never use the heater as a portable appliance without the feet securely fitted using the screws provided.

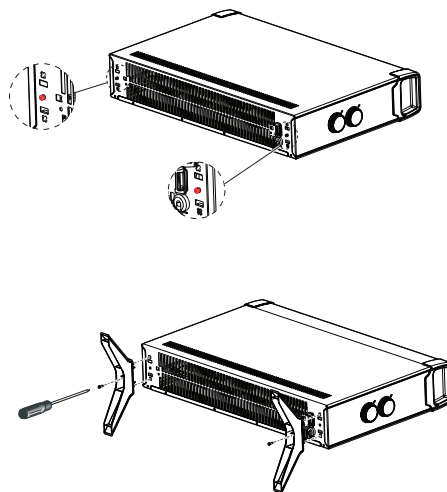

Fig. 2

Operation

IMPORTANT - OBJECTS OR CLOTHING MUST NOT BE PLACED ON THIS HEATER.

Before using the heater ensure that all warnings and instructions have been carefully read.

CONTROLS

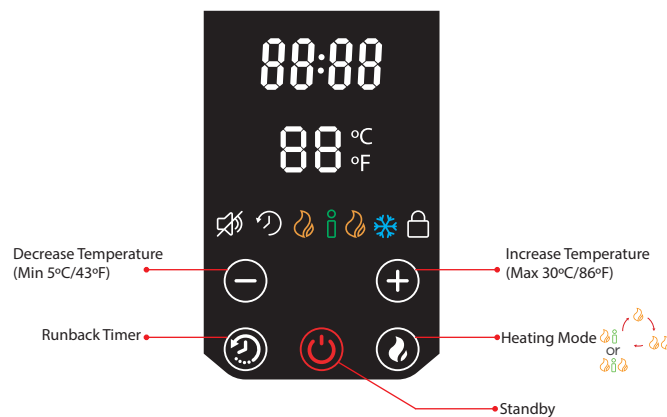

Fig. 3

FIRST TIME STARTUP

To activate the heater, after assembly, simply plug it in. You will hear an audible beep and the standby button will illuminate. This indicates the appliance is energised and ready for use.

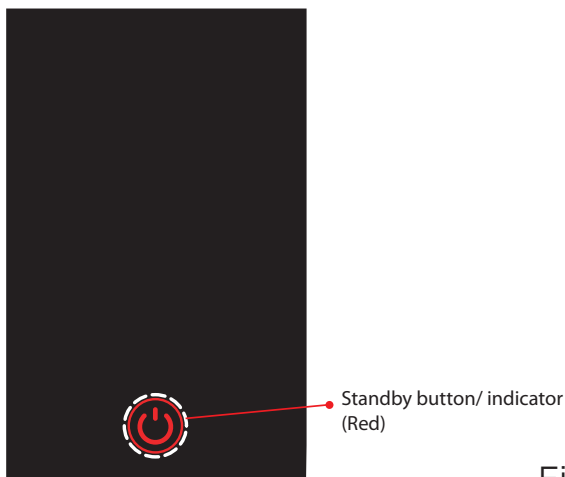

Fig. 4

STANDBY MODE

Standby mode is an inactive mode where the appliance will not emit any heat. In this mode the appliance is plugged in ready for use. Power is going to the product but the product is not turned ON. This mode is indicated by a red standby button/indicator. The screen will be off and no other buttons will be visible, see Fig. 4.

To activate the appliance press the Standby button. The icon will change to green and the screen and buttons will illuminate, see Fig. 5.

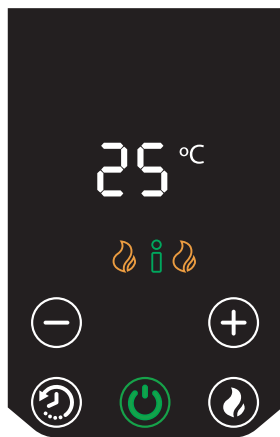

Fig. 5

For first time startup, the product will start with default settings of 25°C in ECO Mode and Manual operation.

If not the first time startup, and when the product is subsequently turned on, the product will return to the last used settings for Heat Mode, Temperature Setting, Sound ON/OFF.

If the product is powered on and the standby button is pressed, there is a countdown timer from 10 to 1 before shutting down.

When disconnected from the power supply (plugged out/ power cut/tilt switch) then reconnected and turned back on, the product will return to last used settings for Heat Mode, Temperature setting, Sound ON/OFF.

Note: The element has been coated with a protective film which will burn off during the first few minutes of use, this may cause a small amount of fuming. This is quite normal – the fumes are non-toxic and will quickly disappear.

We recommend that you open a window to ventilate the room when using the heater for the first time.

Screen & Button sleep mode

If no buttons have been pressed for 20 seconds, the display screen and buttons will enter sleep mode, all buttons except the Standby will disappear and the brightness of the screen icons will dim 50%. To reactivate buttons, place your hand on the display.

The appliance will continue to function as set once the unit is in sleep mode.



OPERATIONAL MODES

This appliance operates in manual mode only:



Manual mode is a continuous active heating mode. It is possible to select a heat mode and a desired room temperature and the appliance will continue to control the room until the mode is changed or the appliance is switched off.



HEAT SELECTION

There are three heat modes to select from, these can be selected during the Operational mode setup:

  Intelligent (Eco) Heat: The product will automatically regulate the output power depending on requirements. In this mode the product operates at full power, however the output of the product is automatically reduced and regulated as the room temperature approaches the desired level. This mode optimises energy use by calculating the most efficient and effective way to achieve the desired temperature setting. The desired room temperature can be adjusted at any time during operation by pressing the appropriate button.

OR

   Low Heat: In this mode, the appliance will operate at a low heat setting, the appliance will automatically cycle at this setting to achieve and maintain the desired room temperature.

  High Heat: In this mode, the appliance will operate at a high heat setting, the appliance will automatically cycle at this setting to achieve and maintain the desired room temperature.

Note: If the temperature set is lower than the room temperature then the product will shut off. The temperature will be flashing to indicate this. The product will stay in this state until the room temperature lowers or the set temperature is increased higher than the room temperature.

	Heat settings		
	Low (w)	High (w)	Eco (w)
ML2CE	800	2000	2000 or 1200 or 800
ML3CE	1000	3000	3000 or 2000 or 1000

SETTING THE 'DESIRED' ROOM TEMPERATURE

The temperature is set using the temperature increase '+' and temperature decrease '-' buttons, see Fig.3. The room temperature can be set in the range between 5°C to 30°C. Please note the temperature indicated on the display represents the desired room temperature. It does not display the actual room temperature.

FROST PROTECTION MODE

The appliance has a frost protection mode. This setting is useful in areas such as garages to assist in the prevention of frost damage.

To activate this mode set the temperature to its minimum setting '5°C', the frost protection symbol (❄️) will illuminate. When set, the heater will cycle ON and OFF to try to maintain a temperature of approximately 5°C and help protect against frost conditions.

Note: This appliance cannot guarantee total frost protection, external factors such as room size, outside temperature, room insulation properties, etc. will effect the reliability of this mode.

RUN BACK TIMER

The heater is fitted with a Runback Timer feature. The Runback Timer will allow the appliance to run, from now, for a pre-set time. After this time has expired the appliance will enter Standby mode and the Runback timer will clear to zero. The Runback Timer range is 1 to 12 hours.

To set Runback Timer press the runback button ⌚, see Fig. 3. The runback icon will begin to flash on the screen and the default runback duration of 1:00 (1 hour) will also appear and flash, see Fig. 6. The runback duration can be adjusted using the '+' and '-' buttons. To accept and set the runback timer simply allow the setup mode to time out (approximately 6 seconds after the last button press). The runback icon and time will stop flashing and be displayed solid on the screen. To cancel the runback setup mode press the standby button while the icon is blinking.

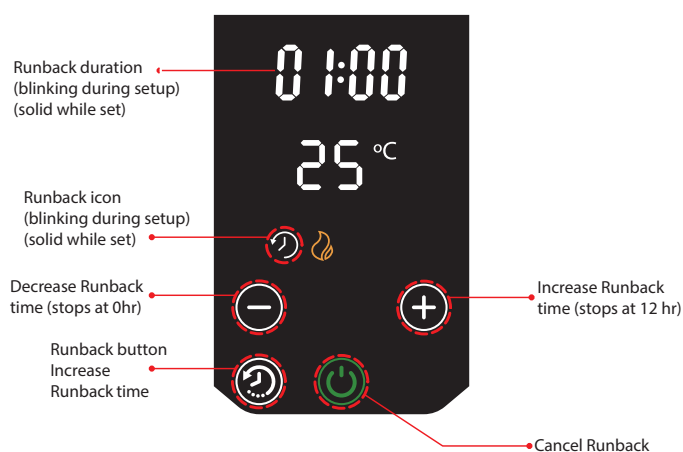

Fig. 6

Current Runback Timer:

The remaining Runback time is displayed on the screen. The Runback button can be pressed and the Runback Timer can be edited or if left alone for 6 seconds will continue in its runback and return to the main screen.

Cancelling Runback Timer:

To cancel the Runback Timer the user can go back into Runback setting and change the Runback time to 0:00 or press the Standby button while the setup mode is active.

DELAYED START TIMER

The heater is fitted with a Delayed Start Timer feature. The Delayed Start Timer will ensure the appliance stays in standby mode until the time has passed. After this time has passed the appliance will activate the previous heat output and setpoint settings. The Delayed Start Timer range is 1 to 12 hours.

To set Delayed Start Timer press and hold the runback button ⌚ for 2 seconds, see Fig. 3. The delayed start icon '⌚' will begin to flash on the screen and the default delayed start duration of 1:00 (1 hour) will also appear and flash.

The delayed start duration can be adjusted using the '+' and '-' buttons. To accept and set the Delayed Start Timer simply allow the setup mode to time out (approximately 6 seconds after the last button press). The delayed start icon and time will stop flashing and be displayed solid on the screen. To cancel the delayed start setup mode while the icon is flashing press the standby button. The appliance will enter standby mode. To cancel after accepting the Delayed Start Timer press the standby button twice.

KEY LOCK

It is possible to lock the controls so that the settings cannot be changed. To activate the key lock press and hold both '⌚' and '🔥' buttons together for 2 seconds, see Fig. 7. The Key Lock icon '🔒' will appear on the display. To unlock the control repeat the action by pressing both '⌚' and '🔥' buttons for 2 seconds.

Note: The Standby button will still work when the Key Lock is active. If the standby button is used again to re energise the appliance then the last heat settings and key lock will still be active.

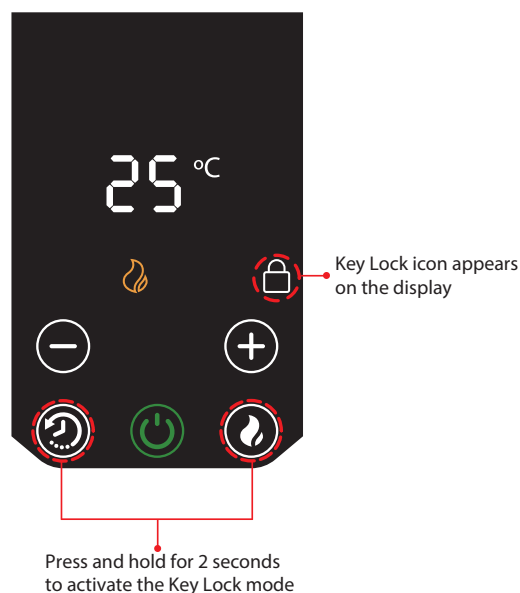

Fig. 7

SOUND ON/OFF

The heater creates the audible beeps when pressing the buttons. To turn off the sound press and hold '🔊' and '−' buttons together for 2 seconds, see Fig. 8. To turn on the sound you have to repeat the action.

Sound OFF - product will not 'beep' on button presses and icon 🔊 will illuminate.

Sound ON - product will 'beep' on button presses and icon 🔊 will be Off.

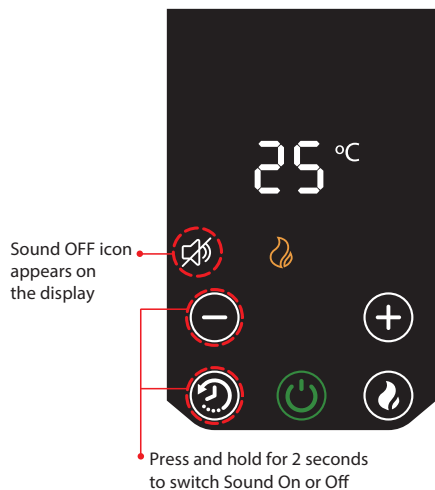

Fig. 8

SWITCHING BETWEEN TEMPERATURE UNITS

To switch temperature from degrees Celsius to degrees Fahrenheit and reverse press and hold '🔊' and '+' buttons together for 2 seconds, see Fig. 9.

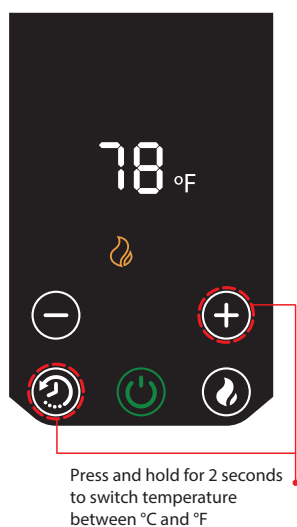

Fig. 9

Safety Features

This appliance incorporates a number of safety devices. In addition to the 'Important Safety Advice' section your attention is drawn to the following:

SAFETY OVERHEAT PROTECTION

The heater is fitted with a thermal cutout which will switch off the heater should it overheat for any reason. If the thermal cutout operates, unplug the unit immediately. Allow the heater to cool down completely and remove the cause of the over heating.

TILT SWITCH

The product is fitted with a safety tilt switch which will prevent the heater from working if the heater is accidentally tipped over in any direction.

If the heater is tipped over while it is hot, disconnect the power and allow it to cool, then stand the heater back upright. Reconnect the power - normal operation should be resumed.

Note: The tilt switch mechanism makes a muted rattling noise when the product is moved or tilted, this is not a fault, this noise is normal.

Additional

IMPORTANT NOTES

Although this heater is manufactured to comply with the relevant safety standards, certain types of carpets could become discoloured by the temperatures under a portable heater. If you are concerned about this, we recommend that you contact the carpet manufacturer for guidance. Alternatively, stand the heater on a suitable base to shield the carpet - call our Helpline for further advice.

You may notice some parts of the element appearing to be hotter from time to time because of the variable airflow through the heater. This does not cause a safety hazard.

The heat outlet grille may become discoloured with use - this is caused by airborne pollution and is not a fault.

STORAGE

If the radiator is not required for long periods, for example during the summer, it should be stored in a dry place and preferably covered to prevent the accumulation of dirt and dust.

CLEANING

WARNING - ALWAYS DISCONNECT THE POWER SUPPLY BEFORE CLEANING THE HEATER.

Do not use detergents, abrasive cleaning powder or polish of any kind on the body of the heater.

Allow the heater to cool, then wipe with a dry cloth to remove dust and a damp cloth (not wet) to clean off stains. Be careful not to allow moisture in to the heater.

RECYCLING

 For electrical products sold within the European Community.

At the end of the electrical products useful life it should not be disposed of with household waste.

Please recycle where facilities exist. Check with your Local Authority or retailer for recycling advice in your country.

If you don't intend to keep the packaging of this product for later use or storage, please dispose of it in an eco-friendly way, please dispose of it in your recycling bin or nearest recycling facility, thank you.

Guarantee

What does a Dimplex Guarantee cover?

Dimplex products deliver reliable service for normal, household use in domestic settings. All Dimplex products are individually tested before leaving the factory.

If you are a consumer and you experience a problem with your Dimplex product, which is found to be defective due to faulty materials or workmanship within the Guarantee Period, this Dimplex Guarantee will cover repair or - at the discretion of Dimplex - replacement with a functionally equivalent Dimplex product.

Your product is under Guarantee for 1 year from the date of purchase or the date of delivery of the product, if later. The 1 year Guarantee is extended for an additional 2 years when you register the product with Dimplex, within 28 days of purchase. If you do not register the product with Dimplex within 28 days, your product will remain warrantied for 1 year only. To validate your extended Guarantee register with us online at: <http://register.dimplex.co.uk>. **N.B.** Each qualifying product needs to be registered with Dimplex individually. Please note that the extended Guarantee is only available in the UK and Ireland.

The Dimplex Guarantee is conditional upon you providing the original purchase receipt as proof of purchase. Please therefore retain your receipt as proof of purchase.

If you do experience a problem with your Dimplex product please call the Helpline on +44 [0]344 879 3588 or visit <https://www.dimplex.co.uk/support>. For ROI please email serviceireland@glendimplex.com or call +353(0)1 842 4833. We will need details of your Dimplex product and a description of the fault which has occurred. Once we receive your information and proof of purchase we will contact you to make the necessary arrangements. If your Dimplex product is not covered by this Dimplex Guarantee there may be a charge to repair your product. However, we will contact you for agreement to any charges before any chargeable service is carried out.

What is not covered by a Dimplex Guarantee?

The Dimplex Guarantee does not cover any of the following:

Any fault or damage to your Dimplex product due to faulty materials or workmanship occurring outside the Guarantee Period. Normal wear and tear including parts that might wear out over time or consumables, such as filters.

Any fault or damage occurring to any pre-owned Dimplex product or to any other equipment or property.

Accidental damage to your Dimplex product or damage to your Dimplex product from external sources (for example, transit, weather, electrical outages or power surges).

Fault or damage to your Dimplex product which is:

- Not due to faulty materials or workmanship or which is due to circumstances outside Dimplex's control.
- Caused by use of your Dimplex product for anything other than normal domestic household purposes in the country where it was purchased.
- Caused by any misuse, abuse or negligent use of the Dimplex product, including but not limited to any failure to use it in accordance with the Operating Instructions supplied with the product.
- Caused by any failure to assemble, install clean and maintain your Dimplex product in accordance with the Operating Instructions supplied with the product unless this was carried out by Dimplex or its authorised dealers.
- Caused by repairs or alterations to your Dimplex product not carried out by Dimplex service personnel or its authorised dealer(s).
- Caused by use of any consumables or spare parts for your Dimplex product which are not Dimplex - specified.

Terms and Conditions

The Dimplex Guarantee is valid for 1 calendar year, plus 2 if registered, from the date of purchase of your Dimplex product from a recognised retailer in the country of purchase and use, or the date of delivery of the product if later, always provided the original receipt has been retained and is produced as proof of purchase.

You must provide to Dimplex or its authorised agents on request the original receipt as proof of purchase and - if required by Dimplex - proof of delivery. If you are unable to provide this documentation, you will be required to pay for any repair work required. Any repair work under the Dimplex Guarantee will be carried out by Dimplex or its authorised dealer(s) and any parts that are replaced will become the property of Dimplex. Any repairs performed under the Dimplex Guarantee will not extend the Guarantee Period.

The Dimplex Guarantee does not entitle you to recovery of any indirect or consequential loss or damage including but not limited to loss or damage to any other property.

The Dimplex Guarantee is in addition to your statutory rights as a consumer and your statutory rights are not affected by this Dimplex Guarantee.

Contact Dimplex

A brand of the Glen Dimplex UK Limited, trading as Glen Dimplex Heating & Ventilation

If you have any questions about what the Dimplex Guarantee covers and does not cover or how to claim under the Dimplex Guarantee, please contact us:

Glen Dimplex Heating & Ventilation, Grange Drive, Hedge End, Southampton SO30 2DF

Telephone: 0344 879 3588

Visit: www.dimplex.co.uk